

KINGAROY MEMORIAL PARK & WJ LANG MEMORIAL POOL



DRAFT CONCEPT MASTER PLAN [E]
PROJECT NO: 21036
DATE 04/11/2022

CLIENT:
 South Burnett Regional Council

LEAD CONSULTANT:
 **Otium**
SPORT + LEISURE + COMMUNITIES

PARTNERS:
 **Stantec**
LIQUID BLU
 **JOHNSON & CUMMING**

 **GREENEDGE DESIGN**
creative thinking | design edge
landscape architecture | master planning | playground design | sports planning

VISION

-  A place for everyone

-  An inviting and welcoming place for all residents and visitors to our region

-  An activated place that offers a diverse and inclusive range of engaging aquatic and recreation opportunities

-  A vibrant gathering place for our community to come together for outdoor events

-  A commemorative place that celebrates our strong cultural and historical significance

-  A healthy place that fosters community wellbeing and liveability

DESIGN PRINCIPLES

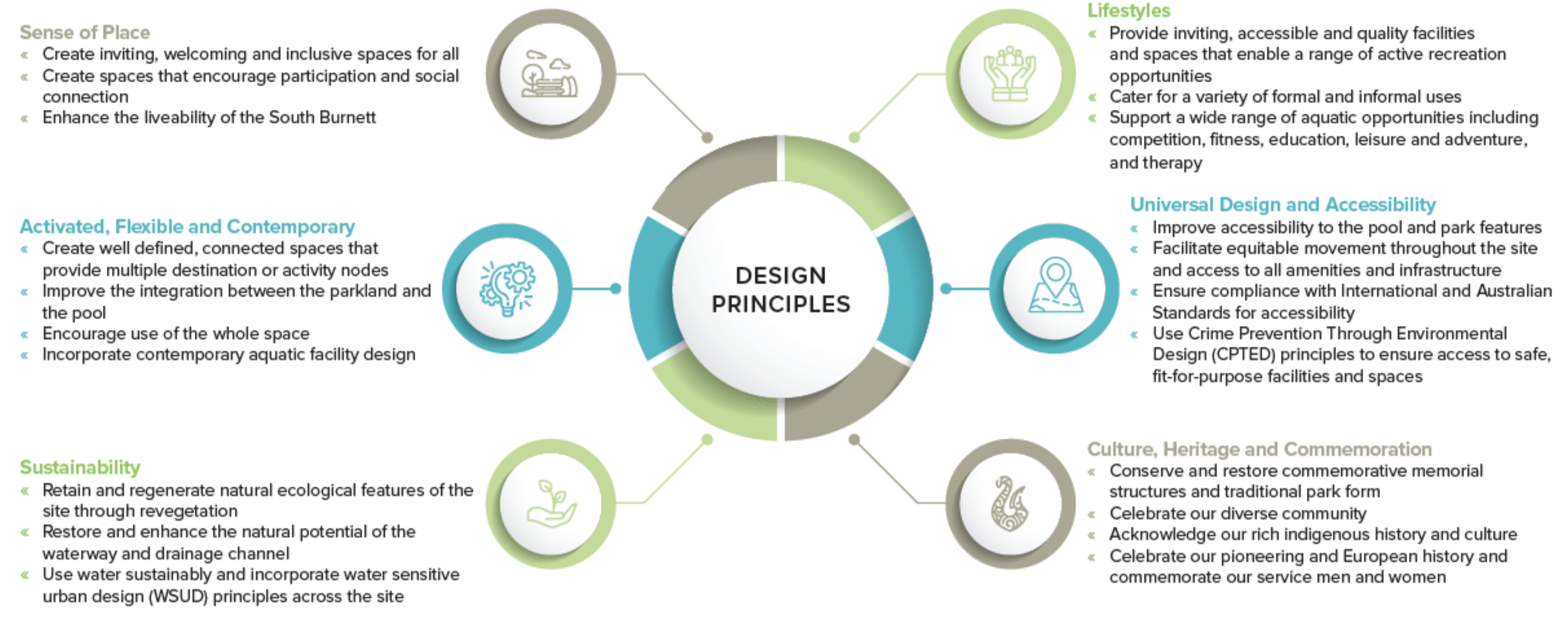

DESIGN INTENT

WAR MEMORIAL
The war memorial will **remain a key feature** and focus of the site with sufficient space for commemorative gatherings. Existing pathways, vehicle and pedestrian access to the memorial area will be **retained and enhanced** and a new commemorative feature will honour those who have served.

RECREATION AND PLAY NODES
The existing play space will be **retained and enhanced** to provide play for very young children through to primary school-aged children. The space will be **universally accessible** and will feature sensory and accessible play features. **Nature play** opportunities and a yarnning circle will create connections to nature and country.

A new **youth play precinct** featuring a multipurpose court, youth play equipment and a parkour/ ninja warrior course will provide exciting and engaging play and socialising opportunities for young people 12 years and older. **A large kickabout space** will be retained to provide a space for informal and spontaneous sporting or recreational activities.

ENTERTAINMENT
An enhanced space for outdoor events will feature a **permanent outdoor stage and power**. Opportunities for community art and historical information sharing will be incorporated throughout the entertainment space.

AQUATIC PRECINCT
A **redesigned, universally accessible aquatic precinct** will feature a new indoor warm water program pool, new entrance, kiosk and amenities and water play.

Outdoor seating external to the aquatic centre will enable park users to utilise the café, creating a nexus between the aquatic centre and Memorial Park.

The existing **50m pool is to be retained** in the short to medium term, with a longer term vision to redevelop the 50m pool, amenities and club facilities.

BOTANICAL PARK AND CONNECTION TO THE REGION
Formal garden beds are retained to complement the formal nature of the war memorial in the eastern area of the site.

An **avenue of trees** planted along the central spine of the park creates a "Heritage Walk" that acknowledges our strong Pioneering, European, and Indigenous history.

A **botanical area** at the western end of the site provides opportunities to feature a range of endemic botanical species to the South Burnett region.

The western end of the Heritage Walk features a **First Nations space**, as well as **sensory and bush tucker trails** that connect with an interpretive trail that weaves throughout the whole site.

Enhanced shade throughout the site and around the perimeter of the site provides increased user comfort and opportunities for botanic interpretation.

PICNIC NODES
A variety of picnic nodes throughout the site, with a **focus on perimeter locations** provide inviting spaces for social gatherings. Picnic nodes are accessible by pathway, feature accessible shelters and barbecues and have adjacent shade.

PARK ENTRIES
Formal park entries are provided on park corners.

NATURAL WATERWAY
A central waterway feature supports an **important drainage function** for the site whilst providing an **attractive recreation space** incorporating trail, picnic, nature play and nature appreciation opportunities. Crossings facilitate access across the waterway at logical points.

PATHWAYS
The historical layout of the path system is **retained and restored**.

A network of **connected pathways** is provided around the whole perimeter of the site and throughout the site to facilitate walking, running and cycling opportunities. Pathways incorporate **interpretive opportunities** and ensure **access to key park activations** such as the playgrounds, picnic nodes and the entertainment precinct.

INTERPRETIVE FACILITIES AND PUBLIC ART
A range of interpretive features are provided **throughout the park** acknowledging war history, pioneering history, Indigenous stories, native plant species and significant history and heritage of the region. **Indigenous and public art** is located throughout the site.

PARKING
On-street parking is **maximised** adjacent to the park, including accessible parking options at key locations.



KINGAROY MEMORIAL PARK

DRAFT CONCEPT MASTER PLAN

PO Box 1640, Buddina, Sunshine Coast, QLD 4575 T: 07 5493 4677 E: admin@greenedgedesign.com.au www.greenedgedesign.com.au

CLIENT:
 South Burnett Regional Council

LEAD CONSULTANT:
 Otium
 SPORT + LEISURE + COMMUNITIES

PARTNERS:
 Stantec
 LIQUID BLU
 JOHNSON & CUMMING

SCALE: AS SHOWN @A1
 DRAWING: MP-01 [E]
 PROJECT: 21036
 DATE: 04.11.2022

 **GREENEDGE DESIGN**
 creative thinking | design edge
 landscape architecture | master planning | playground design | sports planning

OVERALL MASTER PLAN

AQUATIC PRECINCT

- ① 50 metre Outdoor Pool
- ② Indoor Warm Water Pool
- ③ Adventure Slides & Adjacent Water Play
- ④ Plant, Storage and Clubroom
- ⑤ Reception, Kiosk-Cafe, Office & Retail
- ⑥ Entry
- ⑦ Outdoor Dining (Pool Side)
- ⑧ Outdoor Dining (Park Side)
- ⑨ Community Rooms & Amenities

COMMEMORATIVE PRECINCT

- ⑩ Existing Rotunda, Statues & Flagpoles
- ⑪ Existing Mural Wall
- ⑫ New Memorial Walk - Plaques and Stories Inlaid in the Pavement
- ⑬ New Tree Avenue
- ⑭ Extended Path on Axis to William Street
- ⑮ Existing Amenities to be Replaced or Upgraded with Improved Path Access
- ⑯ New Shelter with Seating
- ⑰ Refurbish Existing Formal Park Entry
- ⑱ New Formal Park Entry Pillars

PLAY PRECINCT

- ⑲ Existing Play Equipment & Shade Retained and Enhanced
- ⑳ New Water Play Creek with Handpump
- ㉑ New All Abilities Play Equipment & Sensory Play
- ㉒ Children's Yarning Circle
- ㉓ Nature Play Area within Perched Creek Bed

YOUTH ACTIVITY PRECINCT

- ㉔ Bridge Connecting the Youth Area with the Children's Play Area
- ㉕ Youth Parkour Facilities & Bouldering
- ㉖ Multi-purpose Hardcourt
- ㉗ Chill-out Nodes
- ㉘ Ball Games Rebound Wall
- ㉙ Ninja Warrior Course

STORMWATER CHANNEL

- ⑩ Low Flow Invert Concrete Channel
- ⑪ Wider Gravel Channel with Planting
- ⑫ Existing Trees Retained in Islands
- ⑬ High Flow (Perched) Gravel Channels
- ⑭ Timber Bridge Suitable for Vehicles

INDIGENOUS PRECINCT

- ⑮ First Nations Gathering Place with Interpretive Sculpture & Ceremonial Space
- ⑯ Bush Tucker Garden

BOTANICAL PRECINCT

- ⑰ Local Botanical Displays

PARKLAND

- ⑱ Open Lawn / Kickabout
- ⑳ Picnic Nodes - BBQ, Seating & Shelter
- ㉑ New Universal Amenities Building
- ㉒ Permanent Covered Stage with Storage
- ㉓ Heritage Walk with New Avenue of Trees
- ㉔ Improved Parking on William Street



The Park will have improved lighting throughout; interpretive signage and features; refuse bins (enclosures) at high use areas with good operational access; seating at nodal locations and regular intervals on circuit routes; drinking fountains in key activity areas in the park; and a hierarchy of paths for recreational and passive circulation within the park.

SCALE
1:500 @ A1
1:1000 @ A3

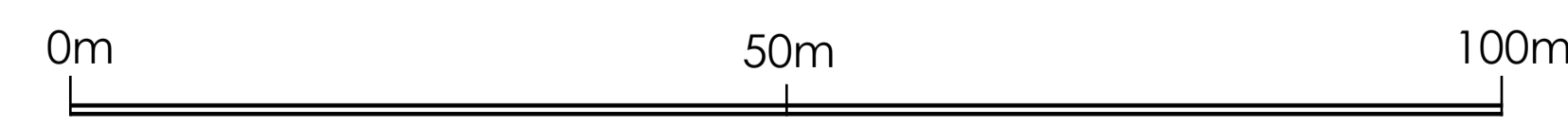

KINGAROY MEMORIAL PARK

DRAFT MASTER PLAN

PO Box 1640, Buddina, Sunshine Coast, QLD 4575 T: 07 5493 4677 E: admin@greenedgedesign.com.au www.greenedgedesign.com.au

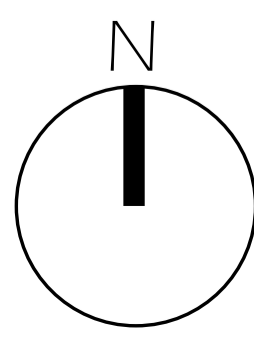

SCALE: AS SHOWN @A1
DRAWING: MP-02 [E]
PROJECT: 21036
DATE: 04.11.2022



GREENEDGE DESIGN
creative thinking | design edge
landscape architecture | master planning | playground design | sports planning

AQUATIC PRECINCT - DETAILED PLAN

AQUATIC PRECINCT

- (A1) New 50 metre Outdoor Pool - 8 Lane
Existing pool to be replaced with additional lanes in future stage
 - (A2) New Indoor Warm Water Programme (WWP) / Learn to Swim (LTS) Pool
 - (A3) Amenities for WWP / LTS / Water Play
 - (A4) Adventure Slides
 - (A5) Water Play Pool / Splash Pad
Includes wet lounge and other surrounding seating options with shade umbrellas / small shelters
 - (A6) Plant Room
 - (A7) Storage & Service Yard
 - (A8) Clubroom with Amenities
 - (A9) Foyer / Reception / Merchandise
 - (A10) Kiosk-Cafe / Kitchen
 - (A11) Office, First Aid & Staff Facilities
 - (A12) Entry
 - (A13) Outdoor Dining (Pool Side)
 - (A14) Outdoor Dining (Park Side)
 - (A15) Community Rooms, Amenities & Storage
Community use rooms including potential space for relocation of the Go Getta Girls
 - (A16) Informal Railing within Planting
Secure railing with planting either side to soften the northern interface with the park - seating platforms in the water play zone offer views to both the aquatic and park areas
 - (A17) Shaded Grandstand
 - (A18) Open Green Area
For event gathering, carnivals or school groups
 - (A19) Planted Street Frontage
 - (A20) Bus Drop Off and Parking
 - (A21) New PWD Parking
 - (A22) New Angle Parking on William Street
 - (A23) Existing Angle Parking, Pedestrian Crossing and Road Infrastructure
-
- ## COMMEMORATIVE PRECINCT
- (C1) Existing Rotunda, Statues & Flagpoles
 - (C2) Existing Mural Wall
 - (C3) New Memorial Walk
Plaques and Stories Inlaid in the Pavement
-
- ## STORMWATER CHANNEL
- (S1) Low Flow Invert Concrete Channel
 - (S2) Wider Gravel Channel with Planting
 - (S3) Existing Trees Retained Along Bank
 - (S4) Timber Bridge Suitable for Vehicles



The Park will have improved lighting throughout; interpretive signage and features; refuse bins (enclosures) at high use areas with good operational access; seating at nodal locations and regular intervals on circuit routes; drinking fountains in key activity areas in the park; and a hierarchy of paths for recreational and passive circulation within the park.

SCALE
1:250 @ A1
1:500 @ A3

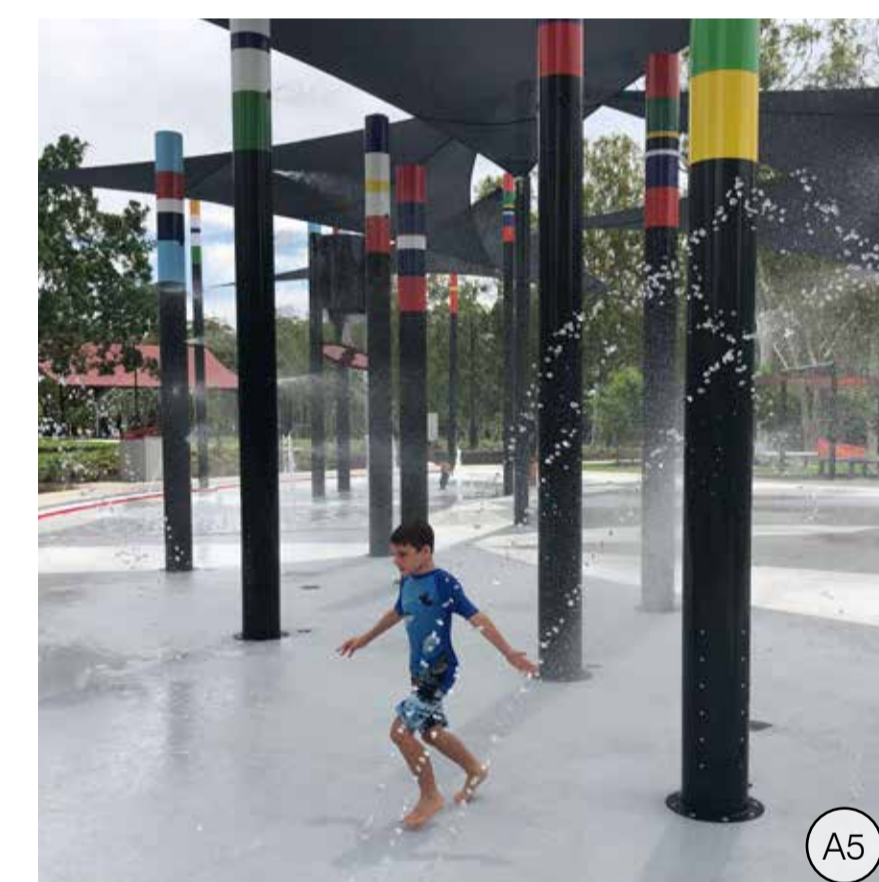
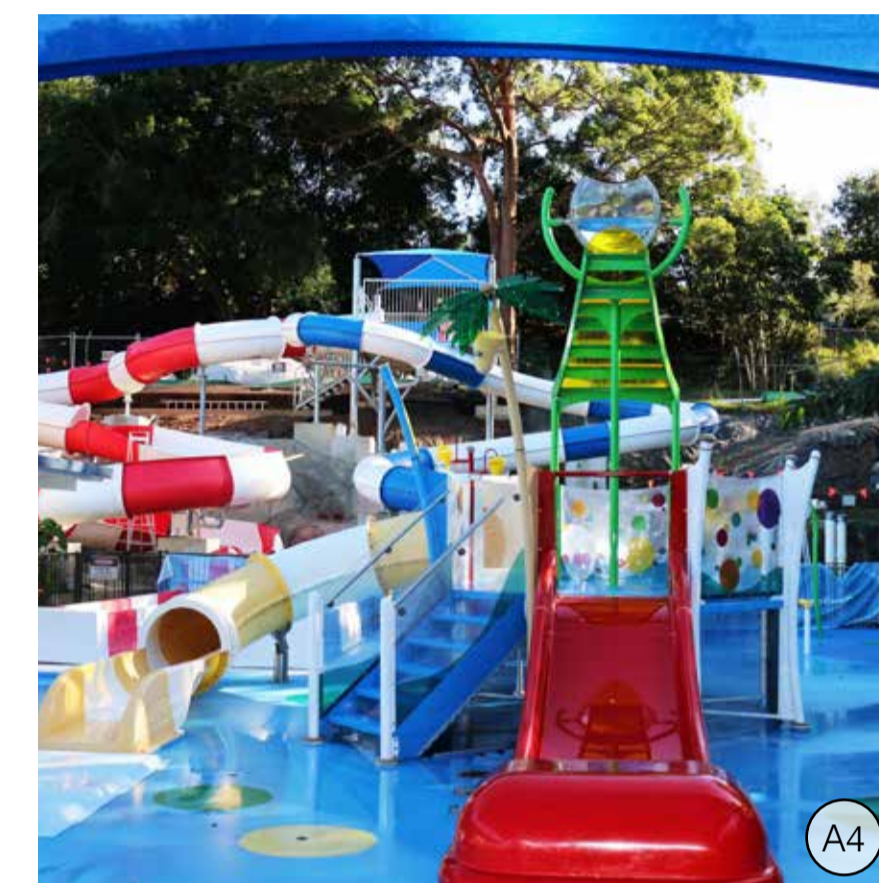
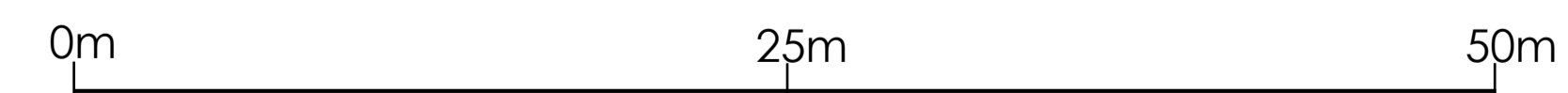

KINGAROY MEMORIAL PARK

DRAFT MASTER PLAN

PO Box 1640, Buddina, Sunshine Coast, QLD 4575

T: 07 5493 4677

E: admin@greenedgedesign.com.au

www.greenedgedesign.com.au

CLIENT:



LEAD CONSULTANT:



PARTNERS:

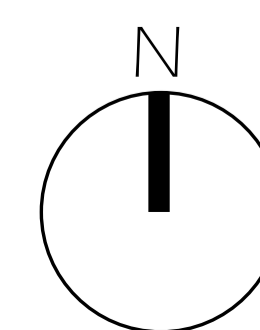

SCALE: AS SHOWN @A1
DRAWING: MP-03 [E]
PROJECT: 21036
DATE: 04.11.2022



GREENEDGE DESIGN
creative thinking | design edge

landscape architecture | master planning | playground design | sports planning



KINGAROY MEMORIAL PARK

DRAFT CONCEPT MASTER PLAN

PO Box 1640, Buddina, Sunshine Coast, QLD 4575 T: 07 5493 4677 E: admin@greenedgedesign.com.au www.greenedgedesign.com.au

CLIENT:
 South Burnett Regional Council

LEAD CONSULTANT:
 **Otium**
SPORT + LEISURE + COMMUNITIES

PARTNERS:
 **Stantec**
LIQUID BLU
 **JOHNSON & CUMMING**

SCALE: AS SHOWN @A1
DRAWING: MP-04 [E]
PROJECT: 21036
DATE: 04.11.2022

 **GREENEDGE DESIGN**
creative thinking | design edge
landscape architecture | master planning | playground design | sports planning

COMMEMORATIVE PRECINCT - DETAILED PLAN

COMMEMORATIVE PRECINCT

- C1 Existing Rotunda, Statues & Flagpoles
- C2 Existing Mural Wall
Retained until the structure is at end of life then a new mural can be applied to the aquatic building's northern wall (behind current mural structure)
- C3 New Memorial Walk
Plaques and stories inlaid in the pavement to honour those who have served in the armed forces
- C4 New Tree Avenue
- C5 Extended Path on Axis to William Street
Suitable for procession vehicles
- C6 Existing Amenities to be Replaced or Upgraded with Improved Path Access
- C7 New Picnic Seating under the Shade of the Existing Trees
New picnic benches on concrete pads with new bins and path connections to William Street
- C8 Refurbish Existing Formal Park Entry
- C9 Open Lawn Area for Larger Gatherings
- C10 Existing Palm Trees Around the Rotunda
- C11 Improved Formal Gardens
- C12 New Wider Path on Existing Alignment
- C13 New Angled PWD Parking
- C14 New Angled Parking
Increasing capacity adjoining park edge and improving safety for road users
- C15 Succession Tree Planting
Gradual removal of Camphor Laurel and replacement with native shade tree species
- C16 New Shade Structure with BBQ Facilities
- C17 Interpretation Signage & Features

AQUATIC PRECINCT

- A24 Aquatic Precinct
- A16 Informal Railing with Planting

PLAY PRECINCT

- P1 Existing Play Equipment & Shade
Retained and Enhanced - Refer Play Precinct Detail Plan

STORMWATER CHANNEL

- S1 Low Flow Invert Concrete Channel
- S2 Wider Gravel Channel with Planting
- S4 Timber Bridge Suitable for Vehicles
- S5 Existing Trees Retained in Islands
- S6 High Flow (Perched) Gravel Channels

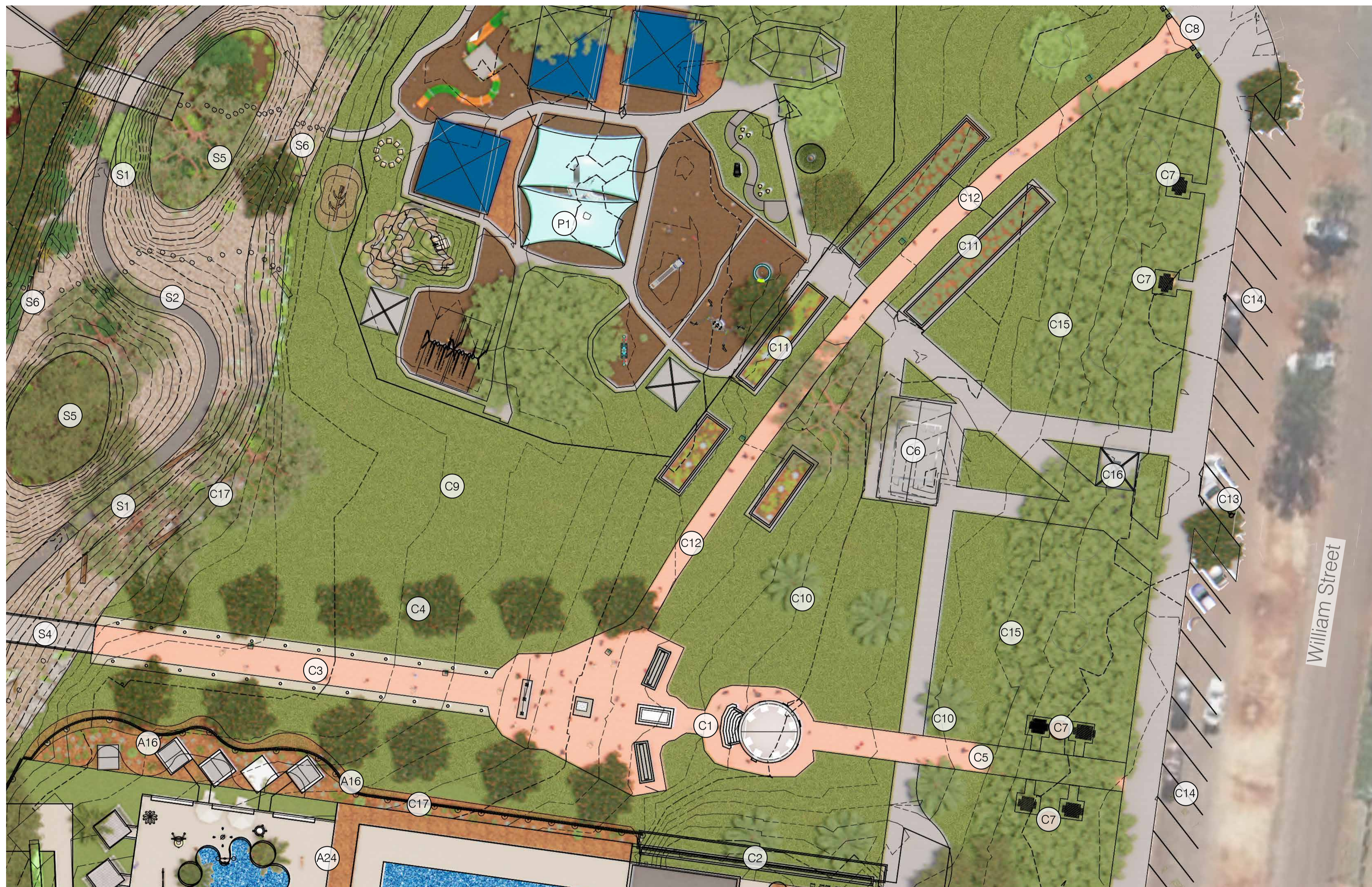

The Park will have improved lighting throughout; interpretive signage and features; refuse bins (enclosures) at high use areas with good operational access; seating at nodal locations and regular intervals on circuit routes; drinking fountains in key activity areas in the park; and a hierarchy of paths for recreational and passive circulation within the park.

SCALE
1:250 @ A1
1:500 @ A3



KINGAROY MEMORIAL PARK

DRAFT MASTER PLAN

PO Box 1640, Buddina, Sunshine Coast, QLD 4575

T: 07 5493 4677

E: admin@greenedgedesign.com.au

www.greenedgedesign.com.au

CLIENT:



LEAD CONSULTANT:



PARTNERS:

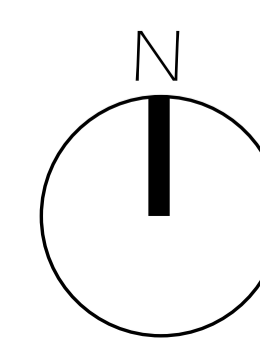

SCALE: AS SHOWN @A1
DRAWING: MP-05 [E]
PROJECT: 21036
DATE: 04.11.2022



GREENEDGE DESIGN
creative thinking | design edge

landscape architecture | master planning | playground design | sports planning



KINGAROY MEMORIAL PARK

DRAFT CONCEPT MASTER PLAN

PO Box 1640, Buddina, Sunshine Coast, QLD 4575 T: 07 5493 4677 E: admin@greenedgedesign.com.au www.greenedgedesign.com.au

CLIENT:
 South Burnett Regional Council

LEAD CONSULTANT:
 Otium
SPORT + LEISURE + COMMUNITIES

PARTNERS:
 Stantec
LIQUID BLU
JOHNSON & CUMMING

SCALE: AS SHOWN @A1
DRAWING: MP-06 [E]
PROJECT: 21036
DATE: 04.11.2022

 **GREENEDGE DESIGN**
creative thinking | design edge
landscape architecture | master planning | playground design | sports planning

PLAY PRECINCT - DETAILED PLAN

PLAY PRECINCT

- (P1) Existing 3-Level Play Tower with Multiple Slides
- (P2) Existing Rockers under Shade Sail
- (P3) Existing Toddler Swings under Shade Sail
- (P4) Existing Junior Swings under Shade Sail
- (P5) Existing Swings (No Shade)
- (P6) Existing Upright Spinner
- (P7) Existing Climbing Frame
- (P8) Existing Freestanding Slide
- (P9) Existing Basket Swing
- (P10) Existing Small Platform with Helter Skelter Slide
- (P11) Existing Doughnut Spinner
- (P12) Existing Seesaw
- (P13) Existing Shade Structure with Seating
- (P14) New Water Play Creek with Hand Pump
Featuring hand pumping of water into a creek system with control gates directing flow.
- (P15) New All Abilities Play Equipment & Sensory Play
Equipment to include: sculptural musical pieces; flat spinning disk, sensory path; and rubber access to equipment suitable for wheelchairs
- (P16) Children's Yarning Circle
- (P17) Nature Play Area within Perched Creek Bed
Area of gravel creek that encourages children to interact with the natural materials such as rocks, timber and gravel rock. Stepping stones define the route with the creek becoming flooded in a larger rain event. Fallen Tree Climb on edge of creek.
- (P18) Existing Fence with New Access Gates
- (P19) New Picnic Facilities with Shelter
Concrete surface under shelter with BBQ, Seating, Bins and Water Bubbler

YOUTH ACTIVITY PRECINCT

- (Y1) Bridge Connecting the Youth Area with the Children's Play Area
- (Y2) Youth Parkour Facilities

STORMWATER CHANNEL

- (S1) Low Flow Invert Concrete Channel
- (S2) Wider Gravel Channel with Planting
- (S5) Existing Trees Retained in Islands
- (S6) High Flow (Perched) Gravel Channels

COMMEMORATIVE PRECINCT

- (C6) Existing Amenities to be Replaced or Upgraded with Improved Path Access
- (C9) Open Lawn Area for Larger Gatherings
- (C11) Improved Formal Gardens
- (C12) New Wider Path on Existing Alignment
- (C15) Succession Tree Planting
Gradual removal of Camphor Laurel and



The Park will have improved lighting throughout; interpretive signage and features; refuse bins (enclosures) at high use areas with good operational access; seating at nodal locations and regular intervals on circuit routes; drinking fountains in key activity areas in the park; and a hierarchy of paths for recreational and passive circulation within the park.

SCALE
1:200 @ A1
1:400 @ A3

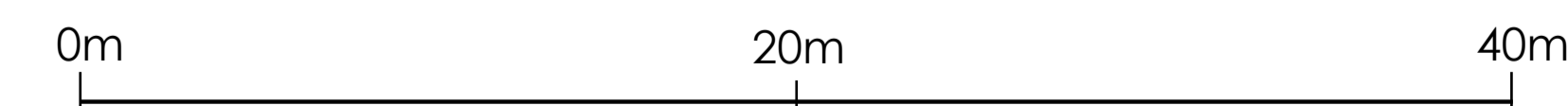

KINGAROY MEMORIAL PARK

DRAFT MASTER PLAN

PO Box 1640, Buddina, Sunshine Coast, QLD 4575

T: 07 5493 4677

E: admin@greenedgedesign.com.au

www.greenedgedesign.com.au

CLIENT:



LEAD CONSULTANT:



PARTNERS:

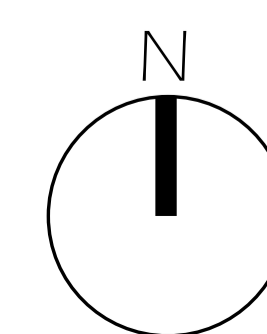

SCALE: AS SHOWN @A1
DRAWING: MP-07 [E]
PROJECT: 21036
DATE: 04.11.2022



GREENEDGE DESIGN
creative thinking | design edge

landscape architecture | master planning | playground design | sports planning



KINGAROY MEMORIAL PARK
 DRAFT CONCEPT MASTER PLAN

PO Box 1640, Buddina, Sunshine Coast, QLD 4575 T: 07 5493 4677 E: admin@greenedgedesign.com.au www.greenedgedesign.com.au

CLIENT:
 South Burnett Regional Council

LEAD CONSULTANT:
 **Otium**
 SPORT + LEISURE + COMMUNITIES

PARTNERS:
 **Stantec**
 LIQUID BLU
 JOHNSON & CUMMING

SCALE: AS SHOWN @A1
 DRAWING: MP-08 [E]
 PROJECT: 21036
 DATE: 04.11.2022

 **GREENEDGE DESIGN**
 creative thinking | design edge
 landscape architecture | master planning | playground design | sports planning

YOUTH PRECINCT - DETAILED PLAN

YOUTH ACTIVITY PRECINCT

- Y1 Bridge Connecting the Youth Area with the Children's Play Area
- Y2 Youth Plaza - Parkour Facilities
- Y3 Multi-purpose Hardcourt
- Y4 Chill-out Nodes
- Y5 Ball Games Rebound Wall
- Y6 Ninja Warrior Course
- Y7 Bouldering Area
- Y8 Shade Structure with Seating Settings
- Y9 Large Shade Structure with Seating Settings
- Y10 Feature Surfacing
- Y11 Path Connection to the Heritage Walk
- Y12 Path Connection to Haly Street Path & On-Street Parking
- Y13 Buffer Planting at top of Creek Bank To trap balls before going into the creek

PLAY PRECINCT

- P14 New Water Play Creek with Hand Pump Featuring hand pumping of water into a creek system with control gates directing flow.
- P16 Children's Yarning Circle
- P17 Nature Play Area within Perched Creek Bed Area of gravel creek that encourages children to interact with the natural materials such as rocks, timber and gravel rock. Stepping stones define the route with the creek becoming flooded in a larger rain event
- P18 Existing Fence with New Access Gates
- P19 New Picnic Facilities with Shelter Concrete surface under shelter with BBQ, Seating, Bins and Water Bubbler

STORMWATER CHANNEL

- S1 Low Flow Invert Concrete Channel
- S2 Wider Gravel Channel with Planting
- S5 Existing Trees Retained in Islands
- S6 High Flow (Perched) Gravel Channels

PARKLAND

- L1 Open Lawn / Kickabout
- L2 Picnic Nodes - BBQ, Seating & Shelter
- L3 Heritage Walk with New Avenue of Trees



The Park will have improved lighting throughout; interpretive signage and features; refuse bins (enclosures) at high use areas with good operational access; seating at nodal locations and regular intervals on circuit routes; drinking fountains in key activity areas in the park; and a hierarchy of paths for recreational and passive circulation within the park.

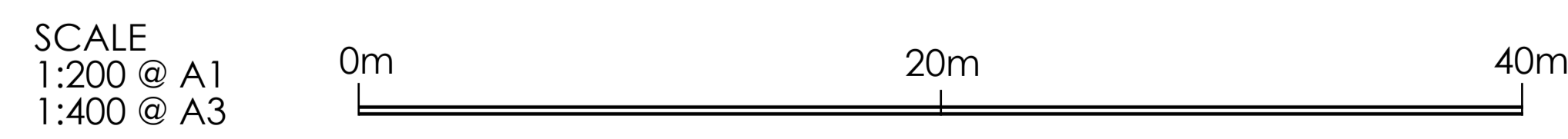

KINGAROY MEMORIAL PARK

DRAFT MASTER PLAN

PO Box 1640, Buddina, Sunshine Coast, QLD 4575 T: 07 5493 4677 E: admin@greenedgedesign.com.au www.greenedgedesign.com.au

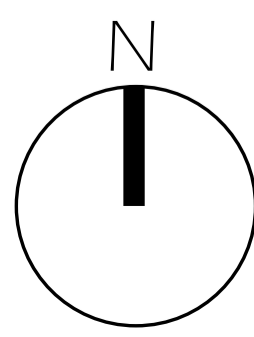

SCALE: AS SHOWN @A1
DRAWING: MP-09 [E]
PROJECT: 21036
DATE: 04.11.2022





KINGAROY MEMORIAL PARK

DRAFT CONCEPT MASTER PLAN

PO Box 1640, Buddina, Sunshine Coast, QLD 4575 T: 07 5493 4677 E: admin@greenedgedesign.com.au www.greenedgedesign.com.au

CLIENT:
 South Burnett Regional Council

LEAD CONSULTANT:
 **Otium**
SPORT + LEISURE + COMMUNITIES

PARTNERS:
 **Stantec**
LIQUID BLU
JOHNSON & CUMMING

SCALE: AS SHOWN @A1
DRAWING: MP-10 [E]
PROJECT: 21036
DATE: 04.11.2022

 **GREENEDGE DESIGN**
creative thinking | design edge
landscape architecture | master planning | playground design | sports planning

INDIGENOUS & BOTANICAL PRECINCT - DETAILED PLAN

INDIGENOUS PRECINCT

- (I1) First Nations Gathering Place with Interpretive Sculpture & Ceremonial Space
- (I2) Sculptural Interpretive Screen With feature lighting
- (I3) Circular Raised Ceremonial Dance Stage
- (I4) Carved Sandstone Seating Blocks
- (I5) Bush Tucker Garden Displays
- (I6) 'Meeting Place' with interpretive references

BOTANICAL PRECINCT

Botanical Precinct will retain the majority of existing trees and interplant new plantings of both rarer and more common local endemic species.

- (B1) Bunya Mountains Botanical Displays Planting and landscape displays that represent the unique environment of the Bunya Mountains. The interface of the Indigenous interpretive trail will also reference the cultural importance the Bunya Mountains have as a meeting place.
- (B2) South Burnett Botanical Displays Planting and landscape displays will showcase the species of the broader region of the South Burnett,
- (B3) Riparian & Wetland Botanical Displays Adjoining and within the creek planting species of the riparian and riverine will be displayed. A small permanent water body will be formed in the channel to sustain some of these species.
- (B4) Botanical Interpretive Trail Stabilised natural looking path with mulch, deco or earth sub-paths in amongst plantings providing access around displays and 'short-cutting' paths. Feature lighting in locations to provide safety at night and avoid formalised light poles in this area.
- (B5) Interpretive Displays and Seating
- (B6) Natural Logs and steppers to provide 'Nature Play' opportunities throughout.
- (B7) Connections Paths to Broader Path Network on the Perimeter or in the Park

PARKLAND

- (L1) Open Lawn / Kickabout
- (L2) Picnic Nodes - BBQ, Seating & Shelter
- (L3) Heritage Walk with New Avenue of Trees
- (L4) New Universal Amenities Drinking Fountain and Bins located here
- (L5) Permanent Covered Stage with Storage Existing building removed. Go Getta Girls to be relocated to new facility at the Aquatic (community buildings) or alternative.
- (L6) New Roadside Path along Burnett Street
- (L7) Shade Shelter with Seating

STORMWATER CHANNEL

- (S1) Low Flow Invert Concrete Channel
- (S2) Wider Gravel Channel with Planting
- (S7) Small Dam for Retaining Water Body for Riparian Botanical Display

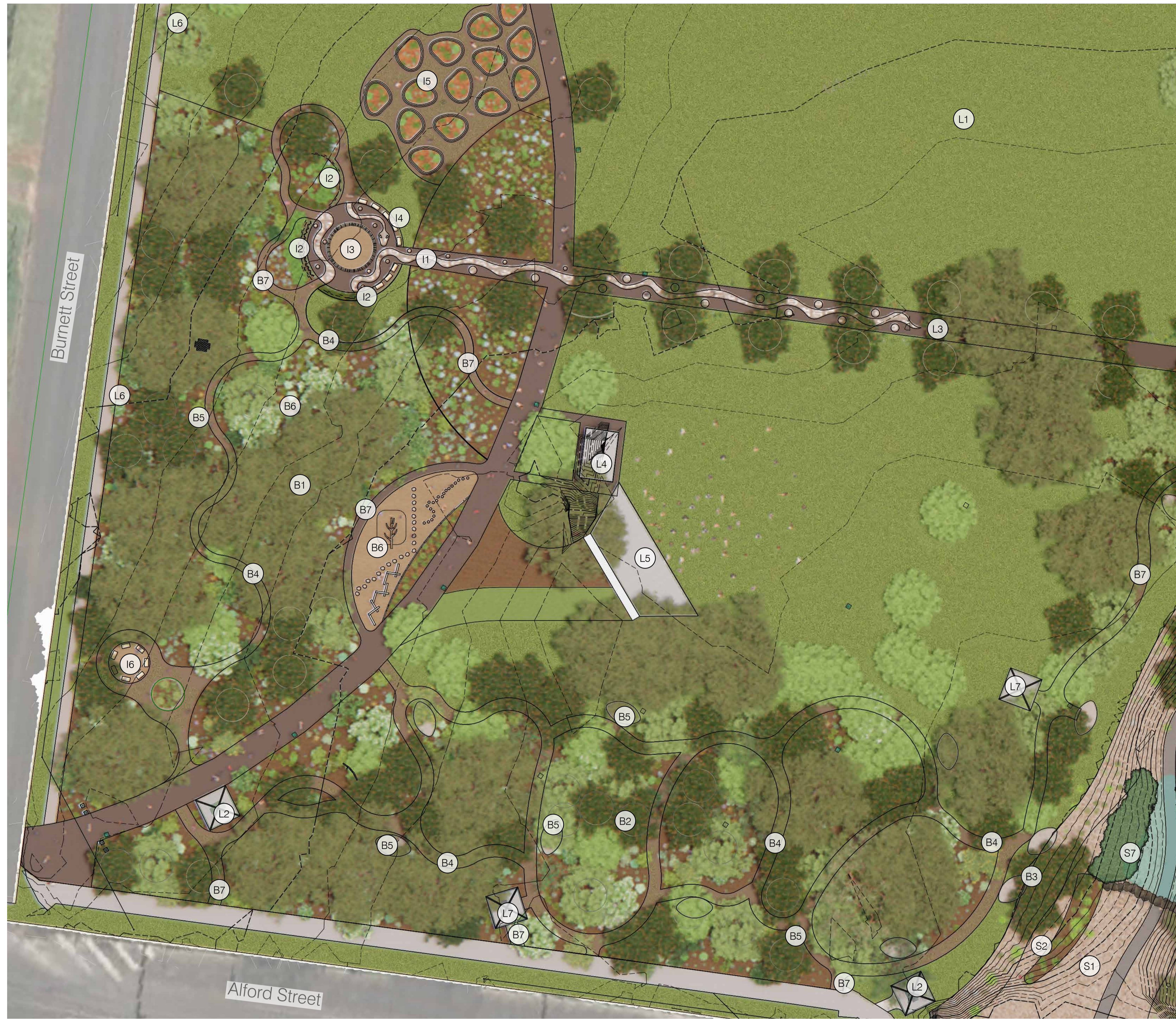

The Park will have improved lighting throughout; interpretive signage and features; refuse bins (enclosures) at high use areas with good operational access; seating at nodal locations and regular intervals on circuit routes; drinking fountains in key activity areas in the park; and a hierarchy of paths for recreational and passive circulation within the park.

SCALE
1:250 @ A1
1:500 @ A3

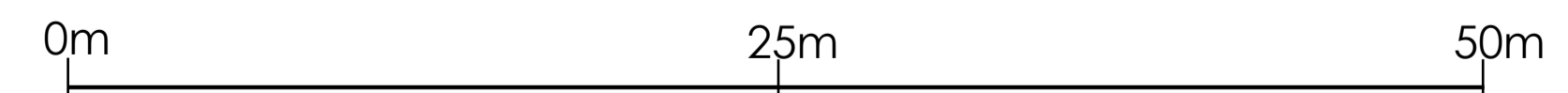

KINGAROY MEMORIAL PARK

DRAFT MASTER PLAN

PO Box 1640, Buddina, Sunshine Coast, QLD 4575

T: 07 5493 4677

E: admin@greenedgedesign.com.au

www.greenedgedesign.com.au

CLIENT:



LEAD CONSULTANT:



PARTNERS:

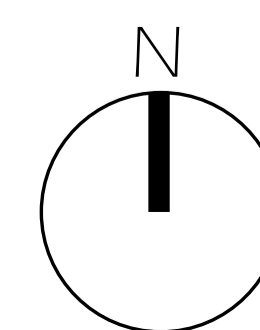

SCALE: AS SHOWN @ A1
DRAWING: MP-11 [E]
PROJECT: 21036
DATE: 04.11.2022



GREENEDGE DESIGN
creative thinking | design edge

landscape architecture | master planning | playground design | sports planning



KINGAROY MEMORIAL PARK

DRAFT CONCEPT MASTER PLAN

PO Box 1640, Buddina, Sunshine Coast, QLD 4575 T: 07 5493 4677 E: admin@greenedgedesign.com.au www.greenedgedesign.com.au

CLIENT:
 South Burnett Regional Council

LEAD CONSULTANT:
 **Otium**
SPORT + LEISURE + COMMUNITIES

PARTNERS:
 **Stantec**
LIQUID BLU
JOHNSON & CUMMING

SCALE: AS SHOWN @A1
DRAWING: MP-12 [E]
PROJECT: 21036
DATE: 04.11.2022

 **GREENEDGE DESIGN**
creative thinking | design edge
landscape architecture | master planning | playground design | sports planning

STAGED MASTERPLAN

WJ LANG OLYMPIC MEMORIAL POOL

Stage One

- New aquatic facilities are located to the north side of the site, above the existing 50m pool concourse.
- Existing 50m pool to be relined.
- New plant & service area to support the new pools are provided at the south-west corner of the site, with vehicular access from Alford Street.
- Existing grandstands, beach volleyball courts, indoor pool, wading pool and associated plant are demolished to facilitate construction of stage one works, including the new entry, associated pathways and William Street frontage.
- The existing entry & amenities building will be closed for the re-lining of the 50m pool & re-open to resume 50m pool operations, upon completion of re-lining / prior to stage one completion.
- Once stage one is completed, the new entry will be used for all site access & the existing entry through the existing building will be closed.

Stage Two

- Access to the 50m pool via the new entry to be closed.
- Existing 50m pool will be demolished.
- Remaining existing buildings and structures to be demolished.
- New 51.5m, 8 lane pool with moveable boom, along with concourses, amenities, plant & equipment, storage facilities & grandstand.
- New adventure waterslides and associated plant and equipment.
- New community facility components, and all associated soft and hard landscaping will be constructed.
- Once stage two is completed, the new entry will be re-opened for all site access.

LEGEND

Stage One

- 1 Indoor Warm Water Programme (WWP) / Learn to Swim (LTS) Pool
- 2 Waterplay Pool
- 3 Amenities / Change—WWP/LTS/ Waterplay
- 4 Amenities—Cafe
- 5 Foyer / Reception / Merchandise
- 6 Kiosk-Cafe / Kitchen
- 7 Office / Administration / Staff
- 8 First Aid
- 9 External Dining
- 10 Open Green Space
- 11 Wet Lounge
- 12 Storage
- 13 Plant Room
- 14 Service Yard
- 15 Entry
- 16 Refurbished Existing 50m Pool (Relined) & Existing Concourse

Stage One (Existing)

- 17 Existing Entry & Amenities Building
- 18 Existing Tensile Shade Structure
- 19 Existing 50m Pool Plant Building
- 20 Existing Swim Club Building
- 21 Stage One Site Fence—Removed for Stage 2

Stage Two

- 22 New 50m x8 Lane Pool with Movable Boom
- 23 Adventure Slides
- 24 Multipurpose Community Room
- 25 Community Room
- 26 Amenities—50m Pool
- 27 Storage
- 28 Shaded Grandstand
- 29 Open Green Space
- 30 Club Room
- 31 Club Room Storage

